

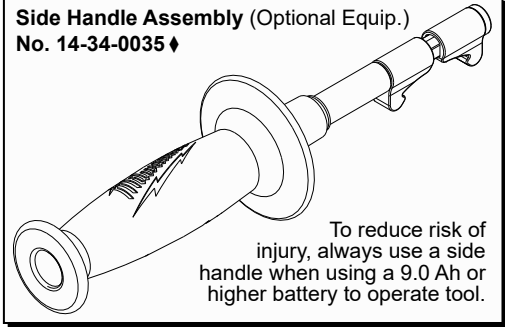

SERVICE PARTS LIST

BULLETIN NO.
54-24-2513

SPECIFY CATALOG NO. AND SERIAL NO. WHEN ORDERING PARTS		REVISED BULLETIN 54-24-2512	DATE Feb. 2021
M18™ 1/2" HAMMER-DRILL			
CATALOG NO.	2607-20	STARTING SERIAL NO.	F25E & F25F
		WIRING INSTRUCTION SEE PAGE 3	



EXAMPLE:
Component Parts (Small #) Are Included
When Ordering The Assembly (Large #).

★ = Part number change from
previous service parts list.

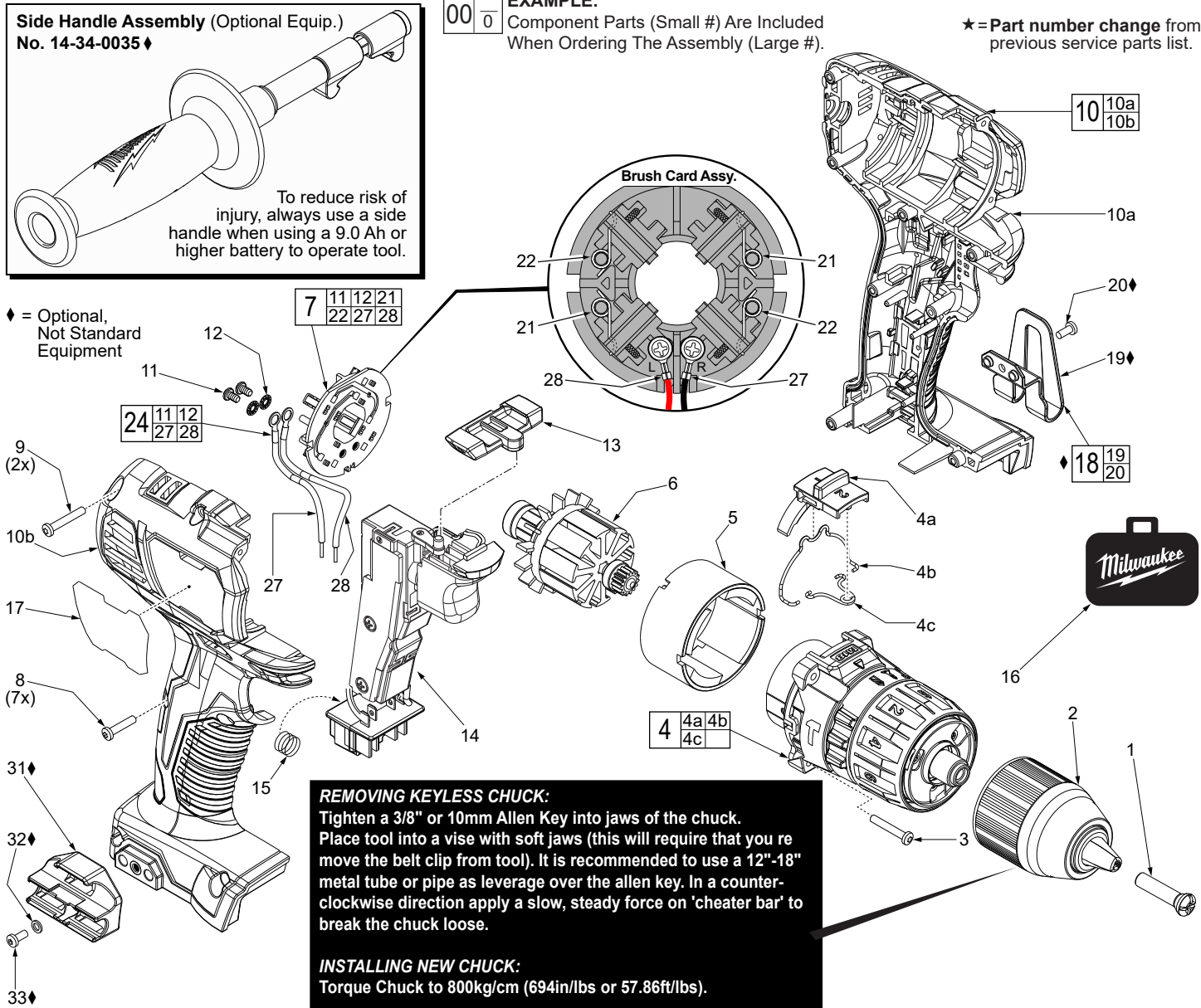
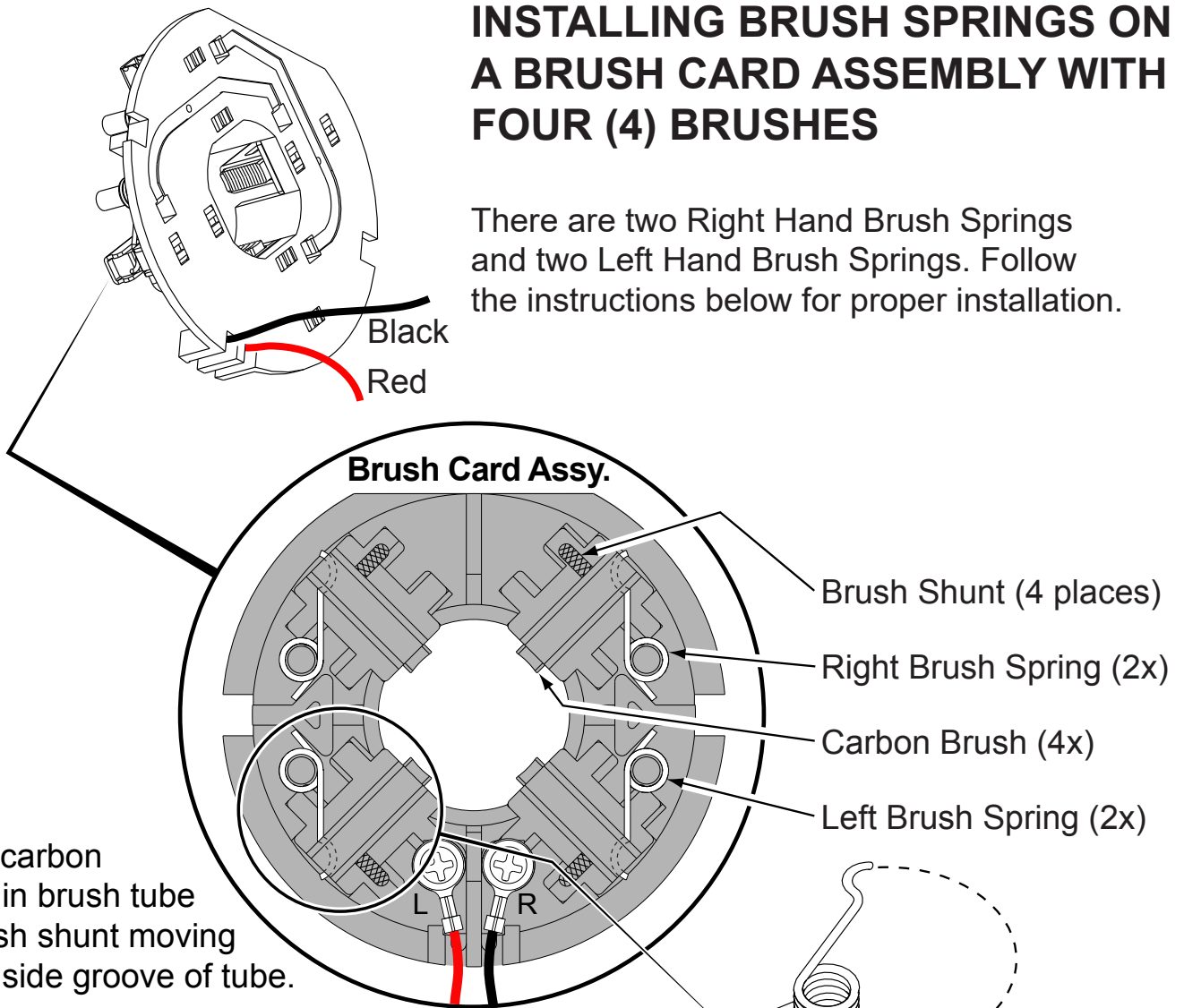

FIG.	PART NO.	DESCRIPTION OF PART	NO. REQ.	FIG.	PART NO.	DESCRIPTION OF PART	NO. REQ.
1	05-88-1500	M6 x 27mm LH Chuck Screw	1	15	40-50-1090	Terminal Block Spring	1
★ 2	42-66-0023	Keyless 1/2" Chuck	1	16	42-55-2606	Blow Molded Carrying Case	1
3	06-82-0135	M3 x 18mm Pan Hd. Plastite T-10 Screw	4	17	12-20-2607	Service Nameplate	1
4	14-29-2607	Gear Box Assembly	1	18	42-70-2653	Belt Clip Assembly, <i>Optional</i>	1
4a	45-24-2607	Speed Selector Slide	1	19	-----	Belt Clip, <i>Optional</i>	1
4b	44-10-2607	Speed Change Lever	1	20	-----	Belt Clip Screw, <i>Optional</i>	1
4c	40-50-2607	Torsion Spring	1	21	-----	Brush Spring - Right Hand	2
5	18-01-3020	Service Field	1	22	-----	Brush Spring - Left Hand	2
6	16-07-2607	Service Armature	1	24	14-46-2394	Leadwire/Screw/Washer Kit	1
7	22-22-2602	Brush Card Assembly	1	27	-----	Leadwire Assembly - Black - Right Side	1
8	06-82-6350	M3 x 16mm Pan Hd. Plastite T-10 Screw	7	28	-----	Leadwire Assembly - Red - Left Side	1
9	06-82-7336	M3 x 20mm Pan Hd. Plastite T-10 Screw	2	31	43-72-0550	Bit Holder, <i>Optional</i>	1
★ 10	31-44-0228	Handle Assembly	1	32	05-90-0225	Washer, <i>Optional</i>	1
10a	-----	Left Handle Halve	1	33	06-82-5275	6-32 x 5/16" Pan Hd. T-15 Screw, <i>Optional</i>	1
10b	-----	Right Handle Halve	1				
11	05-88-0928	M3 x 5mm Pan Hd. T-10 Screw	2				
12	45-88-1980	Spring Washer	2				
13	42-42-2607	Forward/Reverse Shuttle	1				
★ 14	23-66-0296	Electronics Assembly (Consists of Switch, PCBA, LED and Battery Terminal Block)	1				

INSTALLING BRUSH SPRINGS ON A BRUSH CARD ASSEMBLY WITH FOUR (4) BRUSHES

There are two Right Hand Brush Springs and two Left Hand Brush Springs. Follow the instructions below for proper installation.



Be sure carbon brush is in brush tube with brush shunt moving freely in side groove of tube.

Place brush spring over post with short leg positioned downward as shown. Be sure spring is completely down with short leg trapped against 'Y' shaped wall on brush card.

While holding spring in place, bring the long leg of spring over the brush tube and through rear opening of tube. Position rounded hook of spring in groove on back of carbon brush. Be sure to check for free movement between carbon brush, brush shunt and brush spring.

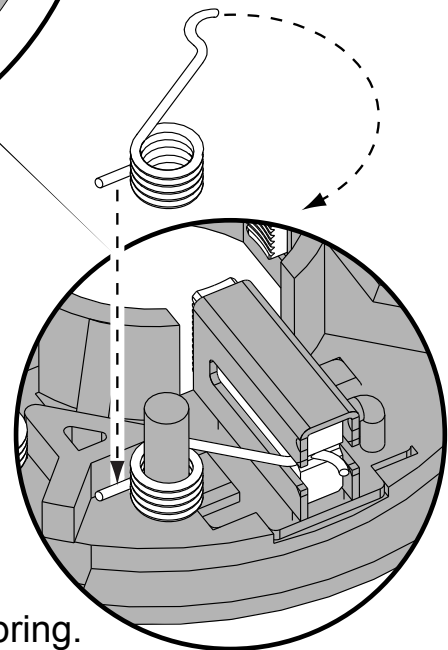

Wrong

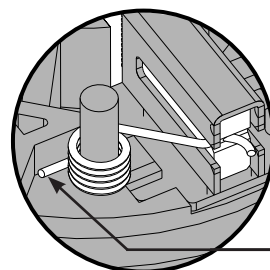

Correct

Short leg of spring to the bottom

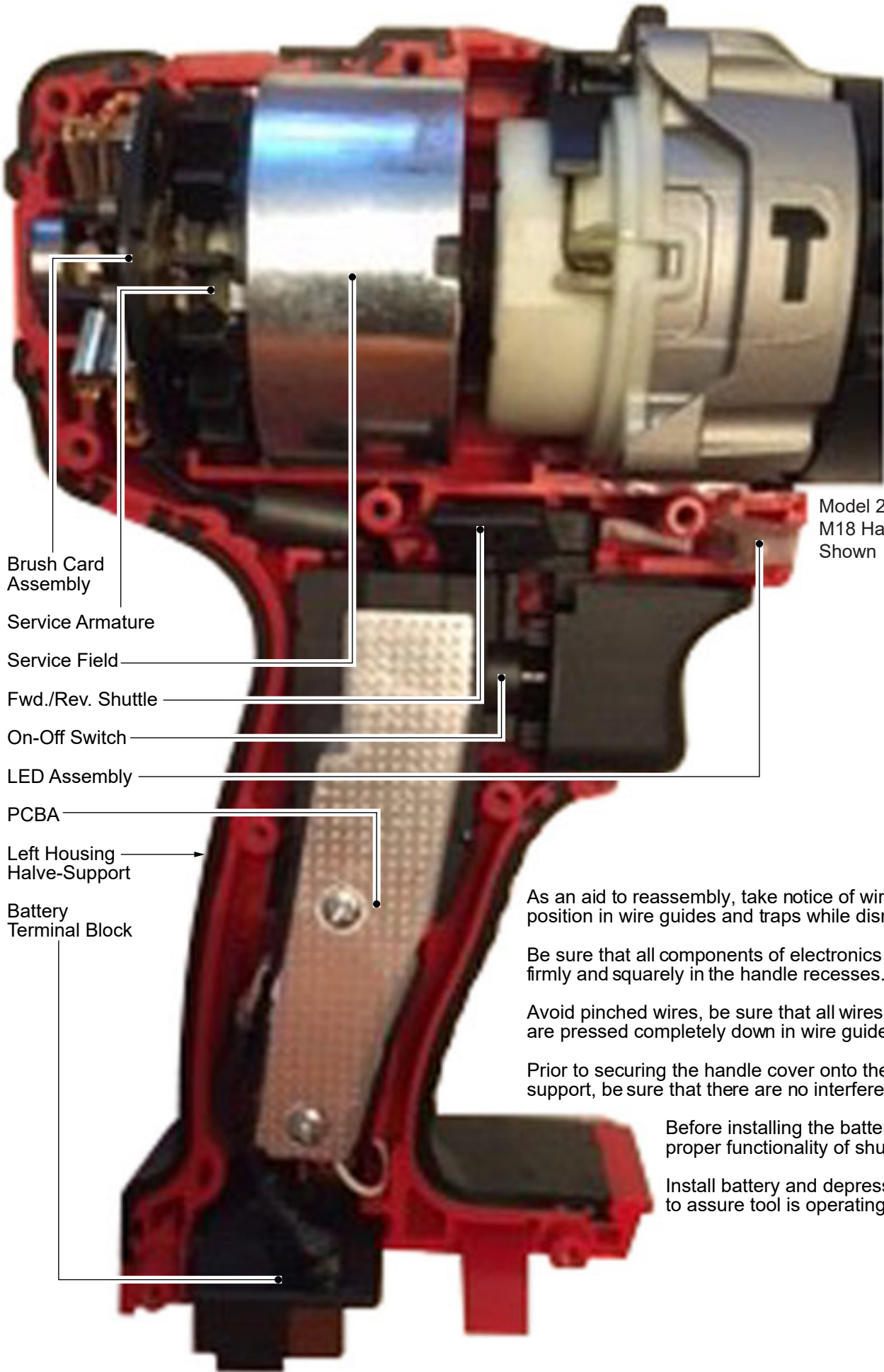

Model 2607-20
M18 Hammer-Drill
Shown

Brush Card
Assembly

Service Armature

Service Field

Fwd./Rev. Shuttle

On-Off Switch

LED Assembly

PCBA

Left Housing
Halve-Support

Battery
Terminal Block

As an aid to reassembly, take notice of wire routing and position in wire guides and traps while dismantling tool.

Be sure that all components of electronics kit are seated firmly and squarely in the handle recesses.

Avoid pinched wires, be sure that all wires and sleeves are pressed completely down in wire guides and traps.

Prior to securing the handle cover onto the handle support, be sure that there are no interferences.

Before installing the battery, check for proper functionality of shuttle and triggers.

Install battery and depress switch trigger to assure tool is operating properly.